

**THE COUNCIL OF THE BOROUGH OF MILTON KEYNES
(VARIOUS ROADS, CALDECOTTE)
(PROHIBITION OF WAITING) ORDER 2017**

The Council of the Borough of Milton Keynes ("the Council") in exercise of its powers under Sections 1(1), 2(1) and (2) and 4 of the Road Traffic Regulation Act 1984 ("the Act of 1984") and of all other enabling powers, and after consultation with the chief officer of police in accordance with Part III of Schedule 9 to the Act of 1984, hereby makes the following Order:-

PART 1

IMPLEMENTATION, CITATION AND DEFINITIONS

1. This Order shall come into operation on the 1st day of April 2017 and may be cited as "The Council of the Borough of Milton Keynes (Various Roads, Caldecotte) (Prohibition of Waiting) Order 2017".
2. In this Order, except where the context otherwise requires, the following expressions have the meanings respectively assigned to them:-
 - "access way" means a length of road sufficient to enable a vehicle to have access to and egress from land or premises in or adjacent to the said road;
 - "Civil Enforcement Officer" ("CEO") has the same meaning as in Section 76 of the Traffic Management Act of 2004;
 - "Council" means The Council of the Borough of Milton Keynes;
 - "delivering" and "collecting" in relation to any goods includes checking the goods for the purpose of their delivery or collection;
 - "disabled persons' badge" has the same meaning as in the Local Authorities' Traffic Orders (Exemptions for Disabled Persons) (England) Regulations 2000;
 - "disabled persons' vehicle" has the same meaning as in the Local Authorities' Traffic Orders (Exemptions for Disabled Persons) (England) Regulations 2000;
 - "goods" includes postal packets of any description, cash or other valuable securities;
 - "goods vehicle" means a motor vehicle which is constructed or adapted for the carriage of goods of any description and which does not exceed 3.5 tonnes gross laden weight;
 - "passenger vehicle" means a motor vehicle (other than a motor cycle or invalid carriage) constructed solely for the carriage of passengers and their effects and adapted to carry not more than twelve passengers exclusive of the driver, and not drawing a trailer;
 - "postal packets" has the same meaning as in Section 125 of the Postal Services Act 2000;
 - "restricted road" means a road which is subject to parking and waiting restrictions;
 - "road" means a highway and any other road to which the public has access;
 - "statutory undertaker" has the same meaning as in Section 329 of the Highways Act 1980;

"telecommunications apparatus" has the same meaning as in the Telecommunications Act 1984;

"traffic sign" means a sign of any size, colour and type prescribed or authorised under, or having effect as though prescribed or authorised under, Section 64 of the Act of 1984.

3. Any reference in this Order to any enactment shall be construed as a reference to that enactment as amended by any subsequent enactment.
4. The plans annexed to this Order identify the roads and areas subject to this Order, provided that where there is any inconsistency between the plans and the Schedules it is the wording of the Schedules which shall prevail.

PART 2

PROHIBITION OF WAITING

5. No person shall except with the permission or under the direction of a police officer in uniform, a traffic warden or a Civil Enforcement Officer (CEO) cause or permit any vehicle to wait at any time in any of the lengths of roads specified in Schedule 1 hereto.
6. Nothing in Article 5 above shall render it a contravention of this Order to cause or permit any vehicle to wait in any of the lengths of roads specified in Schedule 1 for so long as may be necessary
 - (1) to enable goods to be loaded or unloaded from the vehicle;
 - (2) to enable a person to board or alight from the vehicle;
 - (3) If the vehicle is a goods vehicle and is delivering and/or collecting;
 - (4) when the person in control of the vehicle is required by law to stop or is obliged to stop in order to avoid an accident or is prevented from proceeding by circumstances outside his control;
 - (5) for a vehicle to wait whilst any gate or other barrier at the entrance to premises to which the vehicle requires access or from which it has emerged is being opened or closed, if it is not reasonably practicable for the vehicle to wait outside otherwise than in a length of road specified in Schedule 1 to this Order while such gate or other barrier is being opened or closed;
 - (6) to enable the vehicle, if it cannot reasonably be used for such purpose in any other road, to be used in connection with any of the following:-

- a) building, industrial or demolition operations;
 - b) the removal of any obstruction to traffic;
 - c) the laying, erection or repair of any sewer, main, pipe or apparatus for the supply of gas, water, electricity or any telecommunication system defined by the Telecommunications Act 1984;
 - d) use in the service of any undertaker, the Environment Agency or any public authority in pursuance of statutory powers or duties;
 - e) any wedding or funeral;
 - f) use for police, military, fire brigade or ambulance purposes;
 - g) use for the purpose of delivering or collecting postal packets as defined by section 125 of the Postal Services Act 2000;
 - h) the vehicle being specially constructed or adapted for the delivery or collection of money or valuable securities to be used for those purposes in relation to premises in the vicinity;
 - i) to carry out the removal of furniture or household effects to or from a shop, office, depository or dwelling house in the vicinity.
7. In accordance with the Local Authorities' Traffic Orders (Exemptions for Disabled Persons) (England) Regulations 2000, nothing in Article 5 shall render it a contravention of this Order to cause or permit a disabled person's vehicle which displays a disabled person's badge and parking disc in the relevant position in accordance with Articles 8 and 9 hereof to wait in any of the lengths of road specified in Schedule 1 hereto.
8. For the purposes of this Order a vehicle shall be regarded as displaying a disabled person's badge in the relevant position under the Disabled Persons (Badges for Motor Vehicles) (England) Regulations 2000 if:-
- (1) the badge is exhibited on the dashboard or facia of the vehicle so that the front of the badge is clearly legible from the outside of the vehicle; or
 - (2) where the vehicle is not fitted with a dashboard or facia, the badge is exhibited in a conspicuous position on the vehicle so that the front of the badge is clearly legible from the outside of the vehicle.

9. For the purposes of this Order a vehicle shall be regarded as displaying a parking disc in the relevant position under the Local Authorities' Traffic Orders (Exemptions for Disabled Persons) (England) Regulations 2000 if:-
- (1) the disc is exhibited on the dashboard or fascia of the vehicle so that when marked to show the quarter hour period during which a period of waiting began, that period is clearly legible from the outside of the vehicle; or
 - (2) where the vehicle does not have a dashboard or fascia, the disc is exhibited in a conspicuous position on the vehicle so that, when marked to show the quarter hour period during which a period of waiting began, that period is clearly legible from the outside of the vehicle.

PART 3

ENFORCEMENT OF RESTRICTIONS

10. The Council shall, on or in the vicinity of a restricted road:-
- (1) Highlight each restricted area with notices, signs and road surface markings in accordance with the Traffic Signs Regulations and General Directions Act 2002;
 - (2) Maintain and from time to time alter the said notices, signs and road-surface markings;
 - (3) Carry out such other work as is reasonably required for the purpose of the satisfactory operation of a restricted road.
11. The Council shall appoint Civil Enforcement Officers whose duty it shall be to patrol and enforce the waiting and parking restrictions imposed by the Articles of this Order.

SCHEDULE 1

NO WAITING AT ANY TIME

CALDECOTTE LAKE DRIVE, CALDECOTTE NORTH-WEST SIDE

NW1 From its junction with Tilbrook Roundabout, for a distance of 28.5 metres in a westerly direction

NORTH SIDE

NW2 From a point 219 metres south-west of the south-western kerbline of Monellan Grove, for a distance of 21 metres in a westerly direction

- NW3 From a point 250 metres south-west of the south-western kerbline of Monellan Grove, for a distance of 17 metres in a north-westerly direction

SOUTH SIDE

- NW4 From its junction with Tilbrook Roundabout, for a distance of 62 metres in a westerly direction

SOUTH-EAST SIDE

- NW5 From a point 172 metres south-west of its junction with Tilbrook Roundabout, for a distance of 20 metres in a south-westerly direction

- NW6 From a point in line with a point 70 metres south-west of the south-western kerbline of Monellan Grove, for a distance of 21.3 metres in a north-easterly direction

- NW7 From a point in line with a point 92 metres south-west of the south-western kerbline of Monellan Grove, for a distance of 14 metres in a south-westerly direction

- NW8 From a point in line with a point 123 metres south-west of the south-western kerbline of Monellan Grove, for a distance of 11.3 metres in a south-westerly direction

CALDECOTTE LAKE DRIVE AND MONELLAN GROVE, CALDECOTTE NORTH-WEST SIDE AND NORTH-EAST SIDE

- NW9 From a point on Caldecotte Lake Drive 172 metres south-west of its junction with Tilbrook Roundabout, for a distance of 70 metres in a south-westerly then north-westerly direction onto and along Monellan Grove

NORTH-WEST SIDE AND SOUTH-WEST SIDE

- NW10 From a point on Caldecotte Lake Drive 52 metres south-west of its junction with Tilbrook Roundabout, for a distance of 70 metres in a north-easterly then north-westerly direction onto and along Monellan Grove

FELSTED, CALDECOTTE

THE EASTERN ARM

NORTH-EAST SIDE

- NW11 From a point 34.8 metres south-east of the southern kerbline of the northern arm, for a distance of 22 metres in a south-easterly direction

WEST SIDE

- NW12 From a point 54.6 metres south-east of the southern kerbline of the northern arm, for a distance of 8 metres in a south-easterly direction

- NW13 From a point 42.4 metres south-east of the southern kerbline of the northern arm, for a distance of 11.7 metres in a north-westerly then westerly direction

- NW14 From a point 23 metres south-east of the southern kerbline of the northern arm, for a distance of 15.6 metres in a south-easterly then north-westerly direction

THE CENTRAL ISLAND

- NW15 Its entire length circumference, a distance of 29 metres

THE NORTHERN ARM

SOUTH SIDE

- NW16 From its junction with the western arm to its junction with the eastern arm, a distance of 26 metres

THE WESTERN ARM

EAST SIDE

- NW17 From a point 16.4 metres south-west of the southern kerbline of the northern arm, for a distance of 9 metres in a southerly then south-easterly direction

- NW18 From a point 50.4 metres south-west of the southern kerbline of the northern arm, for a distance of 13 metres in a south-easterly then north-westerly direction

THE SOUTHERN ARM

SOUTH SIDE

- NW19 From a point 13 metres south-east south-eastern kerbline of the western arm, for a distance of 9.6 metres in an easterly direction

THE ACCESS ROAD LINKING THE WESTERN ARM AND EASTERN ARM

SOUTH-WEST SIDE

- NW20 From the south-eastern kerbline of the western arm, for a distance of 27 metres in a south-easterly direction

FELSTED AND MONELLAN CRESCENT, CALDECOTTE

NORTH-WEST SIDE AND WEST SIDE

- NW21 From a point on the northern arm of Felsted 65 metres south-west of a point in line with the south-western kerbline of Gatewick Lane, for a distance of 19.7 metres in a north-easterly then northerly direction onto and along Monellan Crescent

MONELLAN CRESCENT, CALDECOTTE

NORTH-WEST SIDE

- NW22 From a point 31.5 metres south-west of a point in line with the south-western kerbline of Gatewick Lane, for a distance of 16.5 metres in a south-westerly then north-westerly direction

MAP 1 FOR ORDER

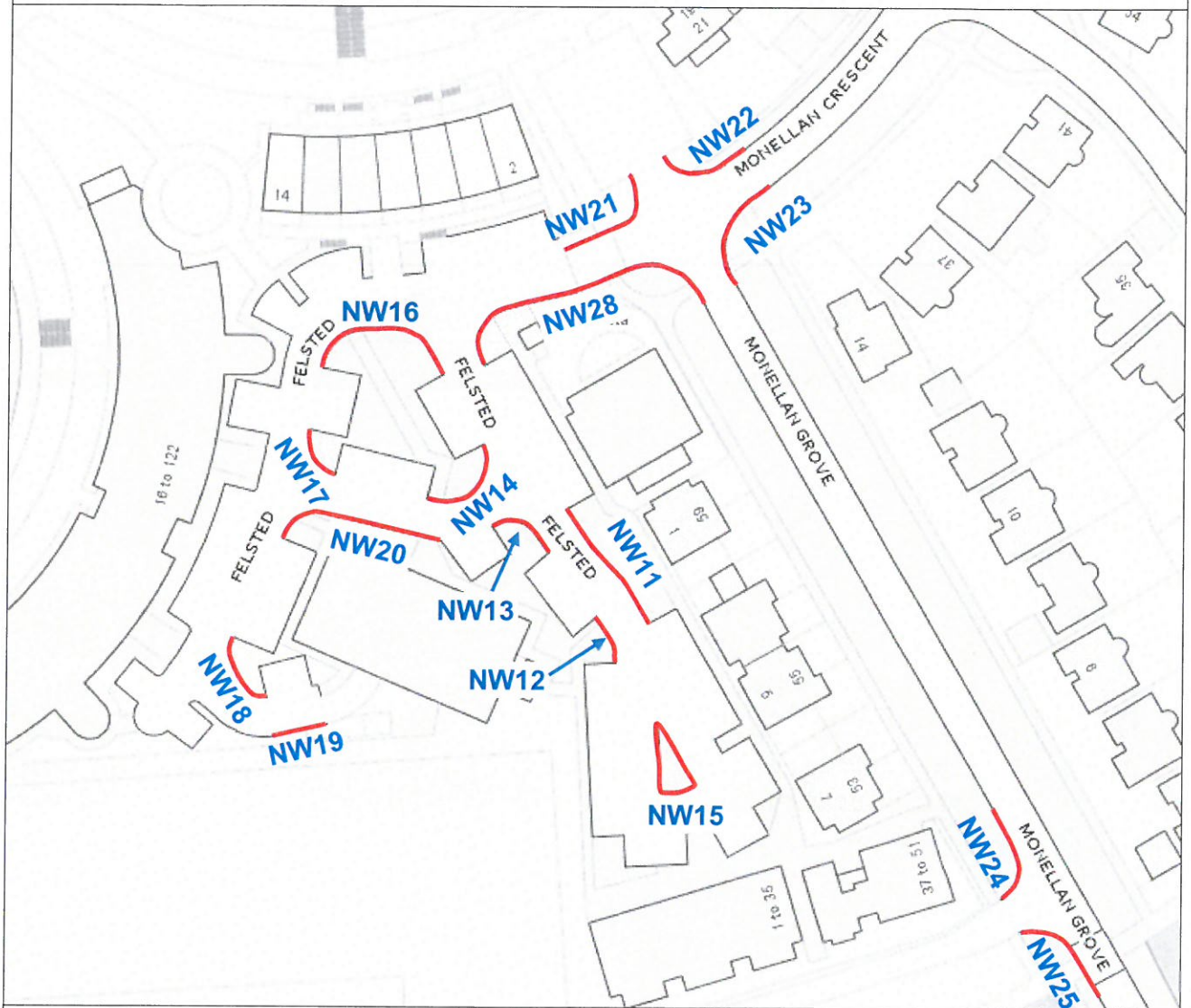

 No waiting at any time restriction

NW11 TRO reference number

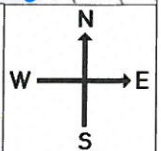

Map referred to in The Council of the Borough of Milton Keynes (Various Roads, Caldecotte) (Prohibition of Waiting Order 2017

This map is not to scale

The Common Seal of the Council of the Borough of Milton Keynes was hereunto affixed in the presence of:





23400

.....
SERVICE DIRECTOR FOR LEGAL AND DEMOCRATIC SERVICES

MAP 2 FOR ORDER

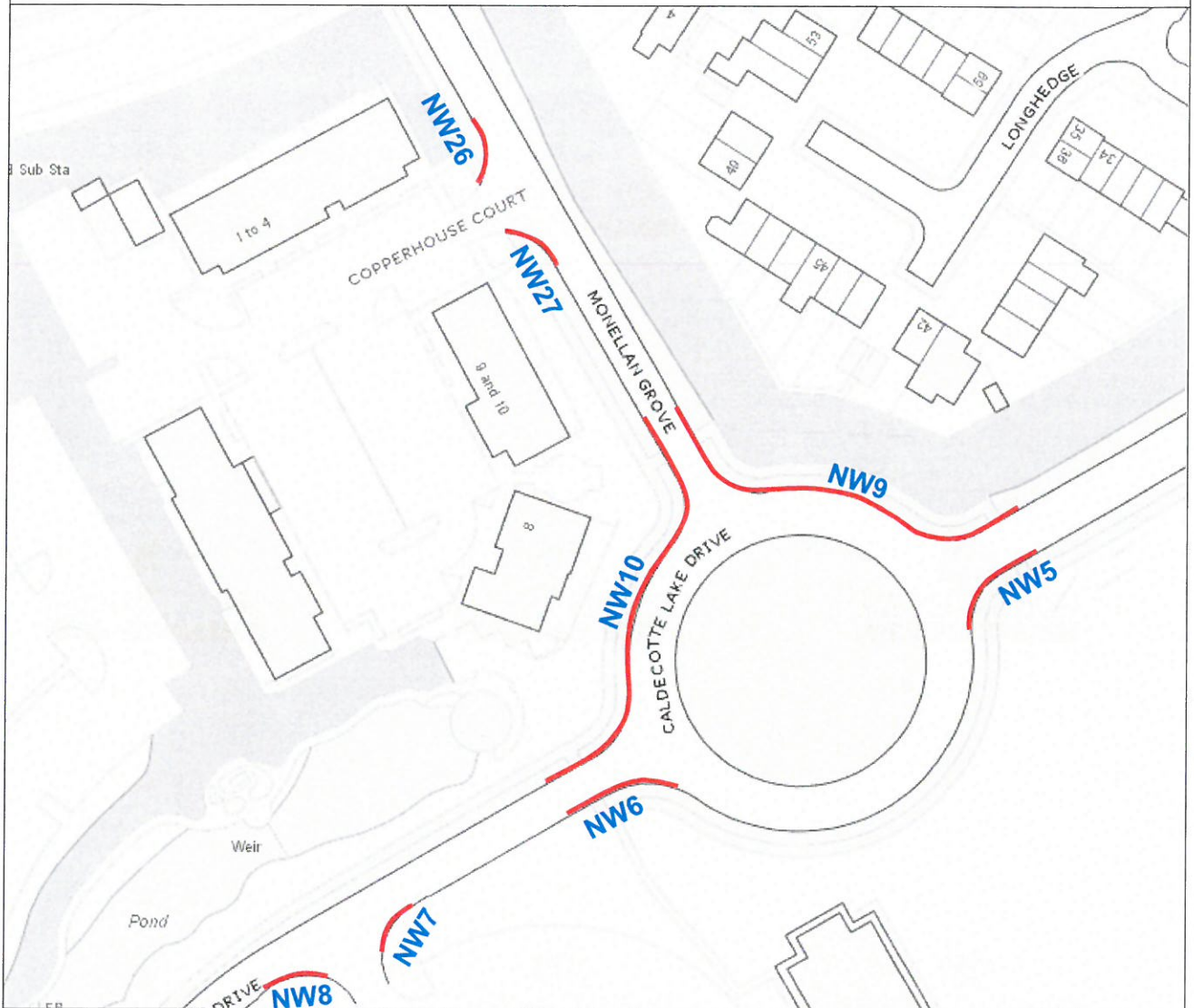

 No waiting at any time restriction

NW5 TRO reference number

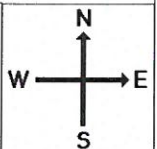

Map referred to in The Council of the Borough of Milton Keynes (Various Roads, Caldecotte) (Prohibition of Waiting Order 2017

This map is not to scale

The Common Seal of the Council of the Borough of Milton Keynes was hereunto affixed in the presence of:



.....
SERVICE DIRECTOR FOR LEGAL AND DEMOCRATIC SERVICES

MAP 3 FOR ORDER

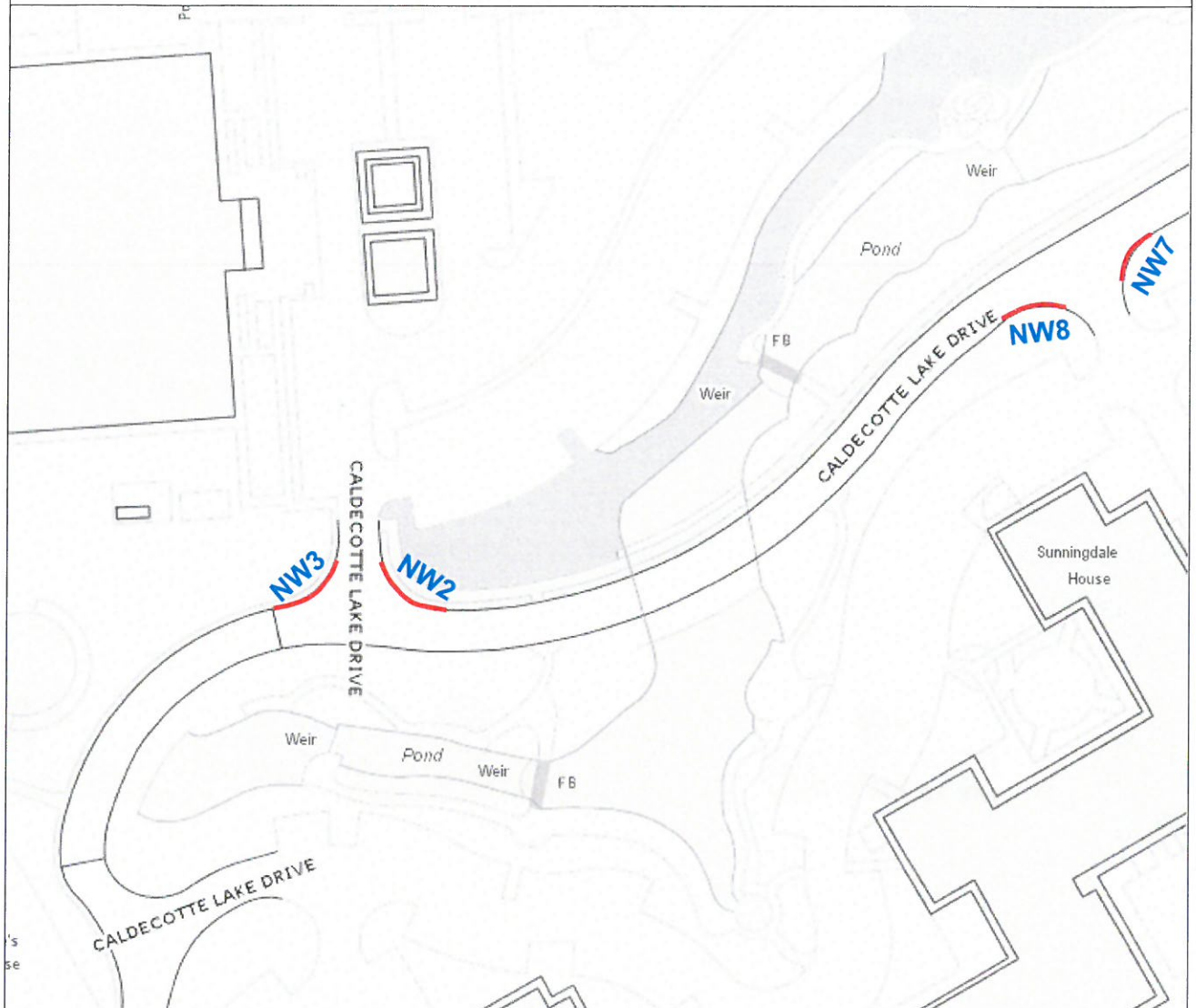

 No waiting at any time restriction

NW2 TRO reference number

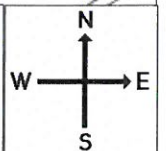

Map referred to in The Council of the Borough of Milton Keynes (Various Roads, Caldecotte) (Prohibition of Waiting Order 2017

This map is not to scale

The Common Seal of the Council of the Borough of Milton Keynes was hereunto affixed in the presence of:





.....
SERVICE DIRECTOR FOR LEGAL AND DEMOCRATIC SERVICES

MAP 4 FOR ORDER

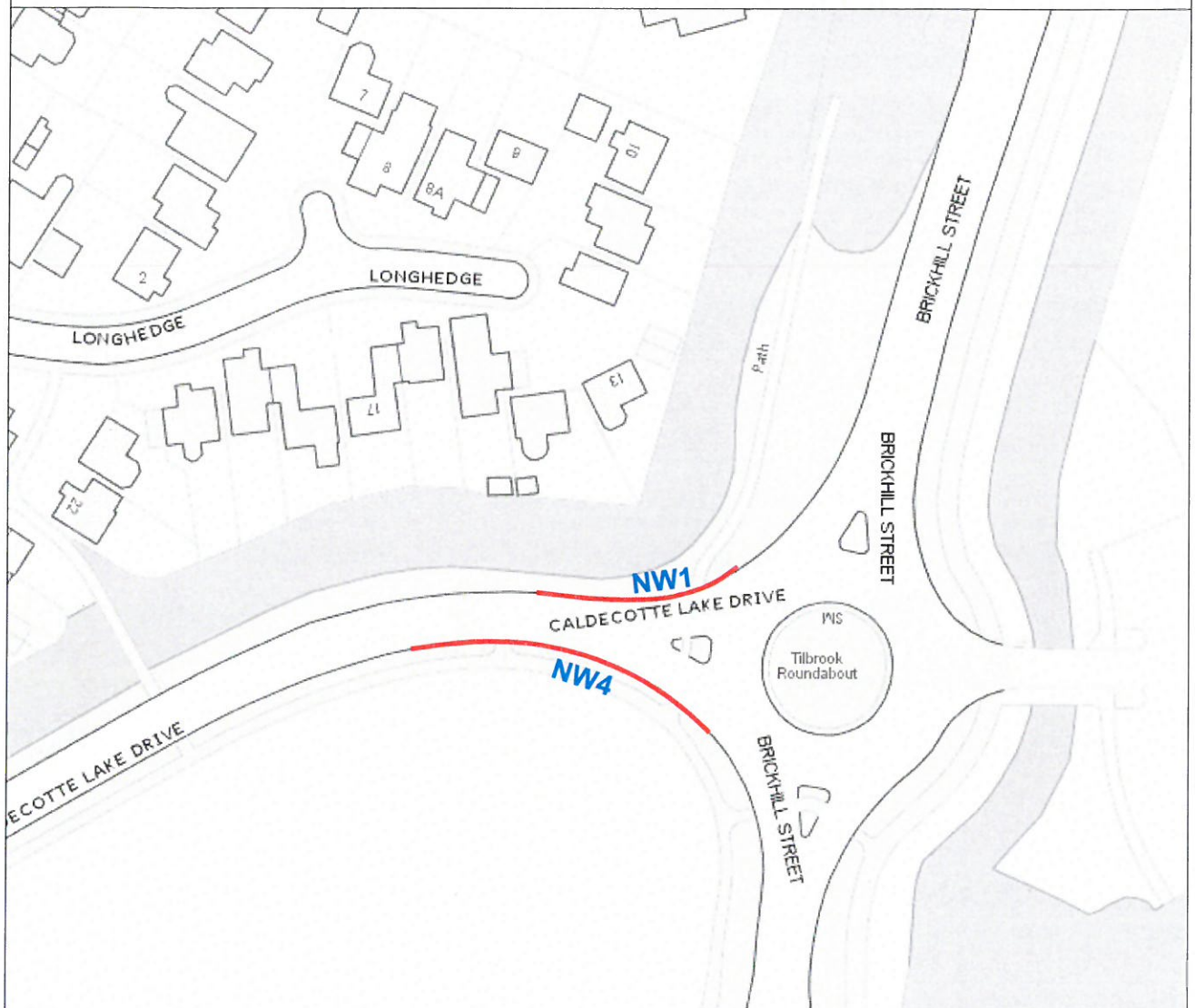

 No waiting at any time restriction

NW1 TRO reference number

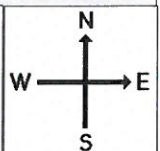

Map referred to in The Council of the Borough of Milton Keynes (Various Roads, Caldecotte) (Prohibition of Waiting Order 2017

This map is not to scale

The Common Seal of the Council of the Borough of Milton Keynes was hereunto affixed in the presence of:

L



.....
SERVICE DIRECTOR FOR LEGAL AND DEMOCRATIC SERVICES

**MONELLAN CRESCENT AND MONELLAN GROVE, CALDECOTTE
SOUTH-EAST SIDE AND NORTH-EAST SIDE**

NW23 From a point on Monellan Crescent 31.5 metres south-west of a point in line with the south-western kerbline of Gatewick Lane, for a distance of 23.5 metres in a south-westerly then south-easterly direction onto and along Monellan Grove

**MONELLAN GROVE, CALDECOTTE
SOUTH-WEST SIDE**

NW24 From a point 56.5 metres north-west of the north-western kerbline of Copperhouse Court, for a distance of 17.8 metres in a south-easterly then south-westerly direction

NW25 From a point 21 metres north-west of the north-western kerbline of Copperhouse Court, for a distance of 24 metres in a north-westerly then south-westerly direction

NW26 From a point 6.3 metres north-west of the north-western kerbline of Copperhouse Court, for a distance of 14.7 metres in a south-easterly direction

NW27 From a point 6.8 metres south-east of the south-eastern kerbline of Copperhouse Court, for a distance of 15 metres in a north-westerly direction

**MONELLAN GROVE AND FELSTED, CALDECOTTE
SOUTH-WEST SIDE AND SOUTH SIDE**

NW28 From a point on Monellan Grove 7 metres south-east of the southern kerbline of Felsted, for a distance of 48.7 metres in a north-westerly the westerly then southerly direction onto and along the northern arm of Felsted

---- END ----

THE COMMON SEAL of the **COUNCIL
OF THE BOROUGH OF MILTON
KEYNES** as hereunto affixed this 28th
day of March 2017 in the presence of:-



.....
SERVICE DIRECTOR FOR LEGAL AND DEMOCRATIC SERVICES